



INTER
SICHERHEITS
SERVICE

PREPARATION FOR ALARM SYSTEM

Dear Sirs,

all our VdS and IMP safes in class III, IV and V produced according to guidelines of norm EN 1143-1 are as standard equipped with holes for mounting components to the alarm system (EMA).

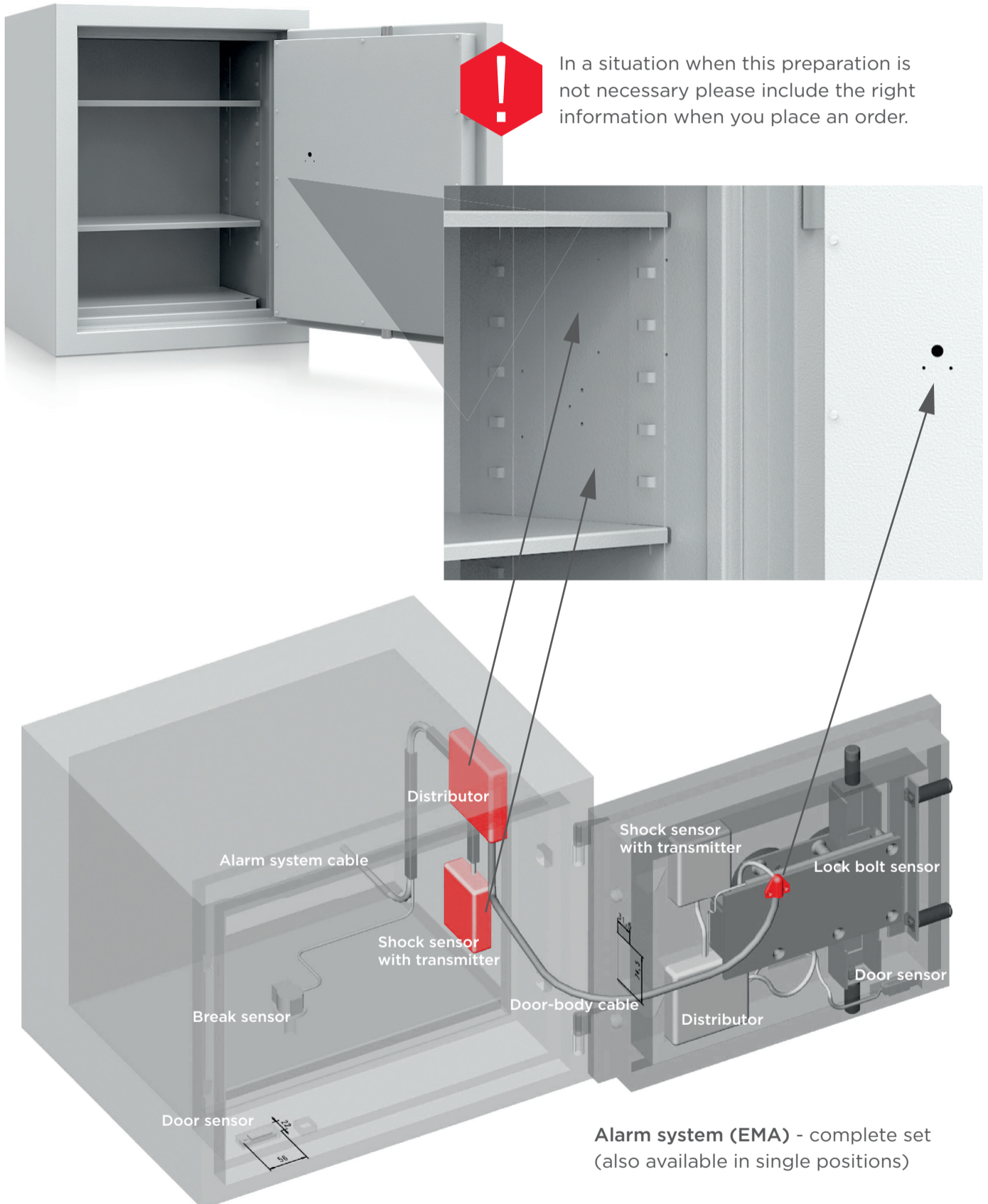

What is an EMA?

The alarm system is an equipment used to receive a signal from alarm detectors, their processing, control and initiation of further transmission which aims to protect people and rooms.

Depending on the components installed the alarm system is designed to:

- reducing the probability of theft, burglary, etc.
- sending alarm signals (to the police or security agencies)
- immediate notification people around one about attempt burglary
- help in the story reconstruction when trying to steal the safe