



Security level: Class S2 according to EN 14450
Security level: according to B VDMA 24992 -
Conditions May '95

Drawer in front with money partition. Max. deposit dimensions H*W*D 100*150*65.

- Suitable for the storage of:
- office documents, office equipment
 - valuables

Description
 Marburg series - drawer in front with money partition.

Body: double-walled body (30 mm thick)
Door: double-walled door construction (84 mm thick)
Locking: 4-way locking bolt system

Standard option
Lock: safe and the drawer, each equipped with high security key lock I class VdS with two keys
Boltwork handle: main door with the knob, faced with the door, the drawer equipped with the grip
Hinges: internal
Door opening angle: 90°
Mounting holes: 2 holes in the floor and in backwall
Colour: RAL 7035 (light grey)



Art. No.	Model	Outer dimensions*			Inner dimensions			Door light		Anchoring		Weight Kg	Shelves Number	Volume Liters
		Height mm	Width mm	Depth mm	Height mm	Width mm	Depth mm	Height mm	Width mm	Bottom number	Backwall number			
35600	Marburg	620	496	410	285	424	294	330	356	2	2	85	1	35
35601	Marburg	820	496	410	485	424	294	530	356	2	2	105	1	60
35602	Marburg	1020	496	410	685	424	294	730	356	2	2	132	1	85

* excluding hinges, handles and fittings

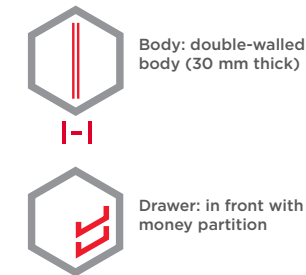

Closure options

Standard option

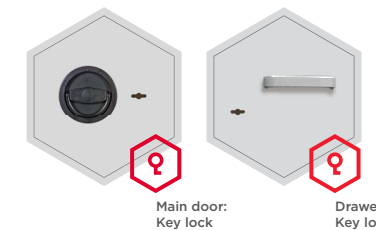

Options available against surcharge

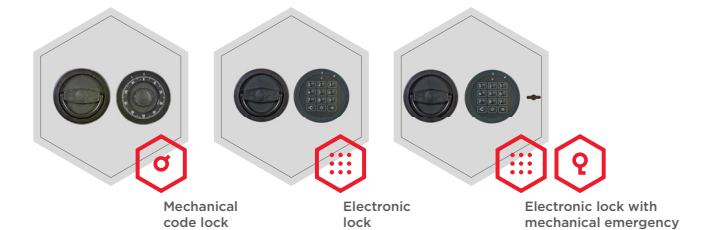

Accessories available against surcharge

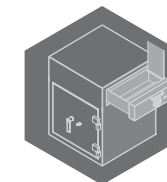

Not protruding drawer / back / side

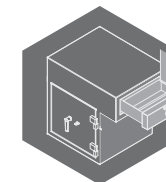

Protruding drawer / back / side

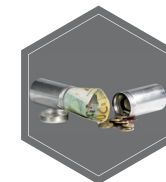

Safe box

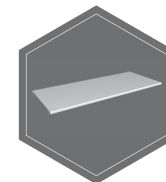

Shelf



All information concerning weight, color and dimensions are noncommittal and subject to errors and changes. Minor deviations are conditional on the production process. Technical changes, modifications and printing errors reserved. Safes may be top-heavy, during commissioning, please exercise appropriate caution in accordance with the installation guide. Pictograms are not technical description of the product.

The picture shows an example of a safe for deposit - model St. Gallen Deposit Art. No. 36261.00 with additional equipment.



Art. No. 35600

